

P 70 ®
 35 PC/HF - ART. 292
 P 36 - ART. 938
 P 52 - ART. 940
 P 70 - ART. 941

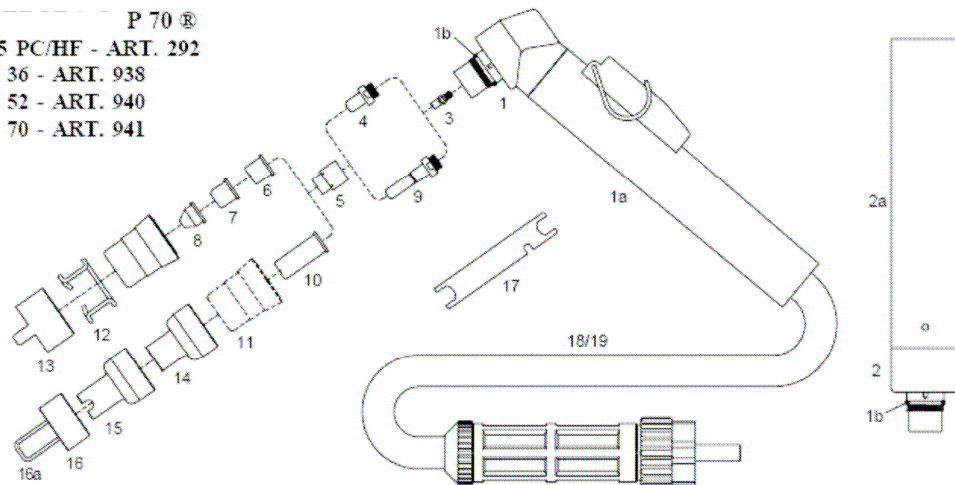

Item	Ref.	Code	Description
	1564	03070/CS	Hand torch complete with 6 mts cable (1/8" connection)
	1573	03071/CS	Hand torch complete with 6 mts cable (central connector)
	1573.20	03171/CS	Hand torch complete with 12 mts cable (central connector)
	1563	03470/S	Machine torch complete with 6 mts cable (1/8" connection)
	1566	03471/S	Machine torch complete with 6 mts cable (central connector)
	1566.20	03571/S	Machine torch complete with 12 mts cable (central connector)
1	1351	01070	Hand torch head
1a	1356	03280/C	Handgrip with microswitch
1b	3.160067	01000.60	O - Ring
2	1349	03370	Machine torch head
2a	3.055.623	03310	Machine handle
3	3.065204	01070.42	Diffusor
4	1402	52551	Electrode
5		60001	Swirling ring
6	1309	51100.09	Tip ø 0.9 - 35A
	1396	51095	Tip long life ø 1.0 - 50A
		51100/S	Tip long life ø 1.1 - 60A
		51096	Tip long life ø 1.2 - 70A
7	1308	51100.12	Tip ø 1.2 - 70A
		51099	Flat tip ø 1.0
		51099.12	Flat tip ø 1.2
8	1305	51098	Conical tip ø 1.0 (Lo - Amp.)
		51098.12	Conical tip ø 1.2
9	1368	52553	Extended electrode
10	1366	51102.09	Extended tip ø 0.9 - 35A
	1395	51095/L	Extended tip long life ø 1.0 - 50A
		51102/S	Extended tip long life ø 1.1 - 60A
		51096/L	Extended tip long life ø 1.2 - 70A
11	5.710.171	60321	Nozzle retaining cap
12	1394	51901	Spacer spring
13	1405	60367	Double pointed spacer
14		51970	Shield cup, hand (for extended tips 51102.09 and 51095/L)
15		51971	Spacer for contact cutting, hand (for extended tips 51102/S and 51096/L)
16		60382	Spacer complete with springs
16a		60383	Spare springs (20 pcs.)
17	3.045.012	60368	Wrench for electrode
18	1344	03240/S	Air and power cable 6 mts 1/8" - Hand torch
		03250/S	Air and power cable 12 mts 1/8" - Hand torch
19		03320/S	Air and power cable 6 mts 1/8" - Machine torch
		03330/S	Air and power cable 12 mts 1/8" - Machine torch